

Surge-Trap® Pluggable SPDs

IEC Standard - AC Protection



Cat. number	Ref. number	Rated Voltage (V)	No of Poles	System Type	Replacement Plug Part No
STP230TNM	H1011041C	230	1	TN	SP275E
STP400ITM	K1011043C	400	1	IT	SP510E
STP230TN1M	M1011045B	230	2	TN (1 Ph + N)	SP275E
STP230TNM	R1011049A	230/400	3	TNC (3 Ph + PEN)	SP275E
STP230TNSM	T1011051A	230/400	4	TNS (3 Ph + N)	SP275E
STP400TNM	E1029875A	400/690	3	TNC (3 Ph + PEN)	SP510HE
STP400TNSM	F1029876A	400/690	4	TNS (3 Ph + N)	SP510HE

IEC Surge-Trap® Pluggable range DIN-Rail SPD offering

Cat. number	Ref. number	Rated Voltage (V)	No of Poles	MCOV (U _c) L-PE	MCOV (U _c) L-N	MCOV (U _c) N-PE	MCOV (U _c) L-L	Voltage Protection Level (Up @ 20 kA), (kV)	Electrical strength (kV)	Freq (Hz)
STP230TNM	H1011041C	230	1	275	N/A	N/A	N/A	< 1.5	2.2	50/60
STP400ITM	K1011043C	400	1	510	N/A	N/A	N/A	< 2.0	2.2	50/60
STP230TN1M	M1011045B	230	2	275	550	275	N/A	< 1.5	2.2	50/60
STP230TNM	R1011049A	230	3	275	N/A	N/A	550	< 1.5	2.2	50/60
STP230TNSM	T1011051A	230	4	275	550	275	550	< 1.5	2.2	50/60
STP400TNM	E1029875A	400	3	510	510	N/A	1020	< 2.0	2.2	50/60
STP400TNSM	F1029876A	400	4	510	1020	510	1020	< 2.0	2.2	50/60

Dimensional diagrams: inches and mm

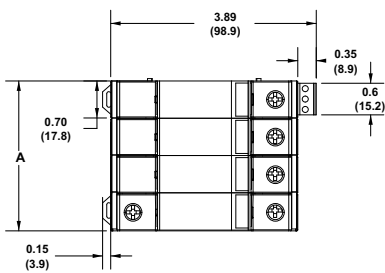

Poles	A (mm)
1	18.03
2	36.06
3	54.10
4	72.13

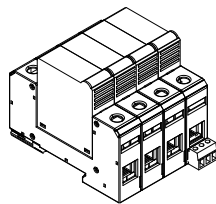
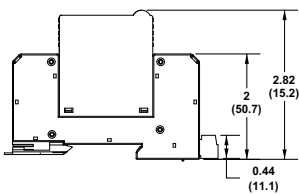

Cat. number	Rated Voltage (V)	Nom. Discharge Current (I _n , 8/20, kA)	Max. Discharge Current (I _{max} , 8/20, kA)	ISCCR (kA)
STP230TNM	230	20	40	25
STP400ITM	400	10	40	25
STP230TN1M	230	20	40	25
STP230TNM	230	20	40	25
STP230TNSM	230	20	40	25
STP400TNM	400	20	40	25
STP400TNSM	400	20	40	25

Surge-Trap® Microswitch Diagram

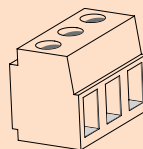

Signal Wire Range: 0.05mm² to 1.31mm²

- Terminal Torque 0.25N.m max
- Cont. between Comm + NO = Product Offline, Not Protected
- Cont. between Comm + NC = Product Offline, Protected